

1.1 Specifications

General

- **Construction:** Heavy-duty steel chassis
- **Disk drive capacity:** Front-accessible eight half-height drives (vertical) and two half-height drives (Horizontal)
- **Cooling system:** Two 49 CFM cooling fans (flow out) in rear panel
- **Controls:** Power On/Off switch on each redundant power supply module in rear panel
- **Indicators:** Bi-color LEDs(green and red) for Power failure, fan failure and overheating
- **Speaker:** One 8 ohm / 0.3Watt speaker, volume control on board
- **Dimensions:** 19"(W) x 8.75"(H) x 19"(D), 482mm(W) x 222.25mm(H) x 482mm(D)
- **Net Weight:** RAID-500 : 37.4 lb (17 Kg), RAID-500M : 55 lb (25 Kg)
- **Paint color:** (Front panel) Pantone Black 4C 2X (Front panel), Optional Pantone 414U (Chassis) Brushed finish, Zinc
- **Operating temperature:** 0 to 50°C (32 to 122°F)
- **Relative humidity:** 20 to 90% @ 40°C (104°F), non-condensing
- **CE Compliant**

Hot-Swappable AC-DC 300-watt Redundant Power Supply (RPS-300V)

- **Output rating:** 300 watts (Max.)
- **Input voltage:** 90 to 135 V_{AC} or 180 to 270 V_{AC} @ 47~63 Hz, switchable
- **Output voltages:** +5 V @ 32 A, +12 V @ 11 A, -5 V @ 1 A, -12 V @ 1 A
(-5V / -12V without output cable)
- **Minimum load:** +5 V @ 3 A, +12 V @ 1 A
- **MTBF:** 100,000 hours at 25°C, 70% Load
- **Safety:** UL/C-UL/TUV/CE Approved

Hot-Swappable DC-DC 300-watt Redundant Power Supply (RPS-300VDC48)

- **Output rating:** 300 watts (Max.)
- **Input voltage:** 40 to 60 V_{DC}
- **Output voltages:** +5 V @ 32 A, +12 V @ 11 A, -5 V @ 1 A, -12 V @ 1 A
(-5V / -12V without output cable)
- **Minimum load:** +5 V @ 3 A, +12 V @ 1 A
- **MTBF:** 100,000 hours at 25°C, 70% Load
- **Safety:** UL/C-UL/TUV/CE Approved

1.2 Fault Detection and Alarm Notification

- **Power failure:** It works only when you install the redundant power supply. If either of the two power modules fails, the dedicated LED (PWR) changes color from green to red also audio alarm. The dedicated LED remains red for failed power module until it fixed.
- **Fan failure:** If either of the two cooling fans fails, the dedicated LED (Fan) changes color from green to red also audio alarm. The dedicated LED remains red for failed fan set until it fixed.
- **High Temperature:** If the chassis interior temperature exceeds 65°C(149°F)(standard setting), the LED changes color from green to red also audio alarm. The LED remains red until the temperature goes below 63°C

Temperature select : The temperature can be set on four status by adjust the switch on alarm board : 65°C (Default setting) , 55°C , 70°C and 75°C

- **Audible Alarm:** Speaker is activated (continous beep)as soon as a malfunction is detected and sounds until the alarm reset button is pressed. The alarm reset button is on front panel. However, the alarm indicator will stay red until the fault condition is resolved. If the Temp board has not well-connected or the sensor is failed, the speaker will alarm as " Beep x Beep x ...".

Temperature also can be selected (S1) on the alarm board inside the chassis :

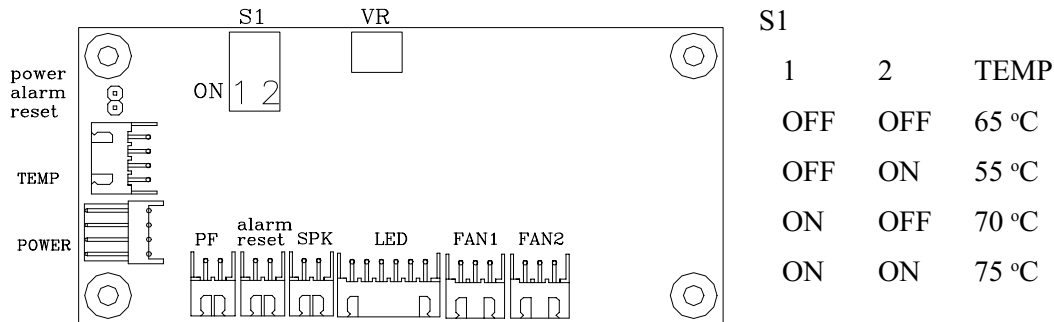

1.3 Disk Cartridge (Only for RAID-500M series)

Features

- Aluminum frame and carrier (front panel color is black)
- Frame dimension is fitted into standard half-height drive bay
- Carrier can be installed one 1" high harddisk drive
- 68-pin Ultra-wide SCSI interface
- Keylock for security : Turn the keylock to the position "OFF" will power off the removable storage
- Built-in cooling fan for reliable operation
- Built-in SCSI ID selector switch on the rear panel of cartidge and display with 7-segments LED on the front panel
- Two activity LEDs : Power LED (color in red) and drive access LED (Bi-color)
- CE compliant

Install the Harddisk into the disk cartridge

Slide out the carrier of disk cartridge, open the cover of carrier. You can install the harddisk into the disk carrier. Then, Slide back the carrier into the frame. See the following figure.

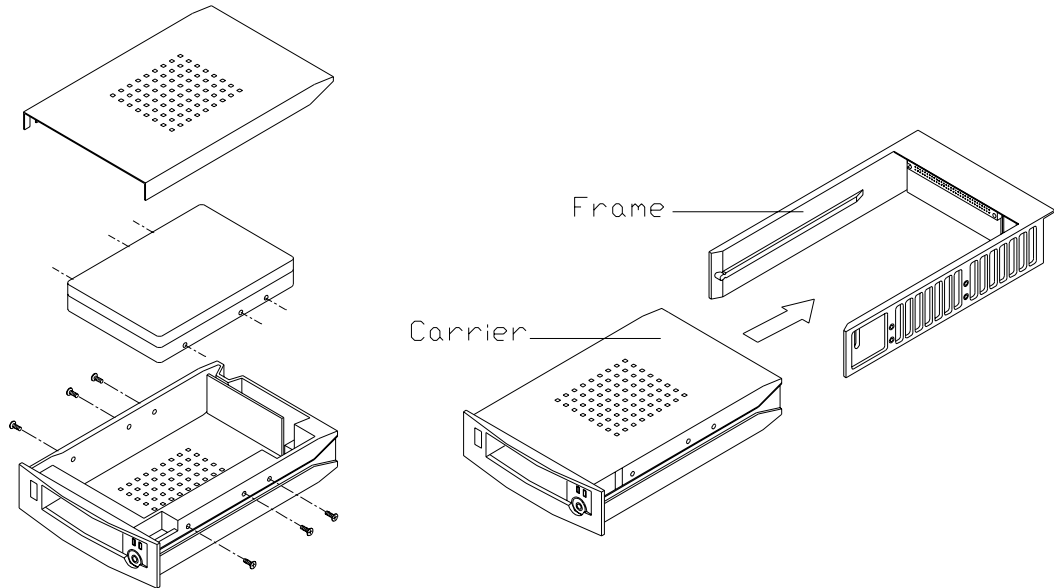

Setup the SCSI ID

Pull out the cardage from removable storage kit, you will see a switch on the rear side of the cardage. Please refer to the following figure. Use the suitable thumbscrew and switching the number to the destined SCSI HDD' ID.

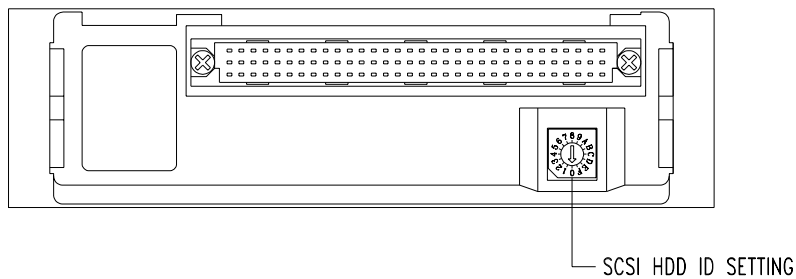
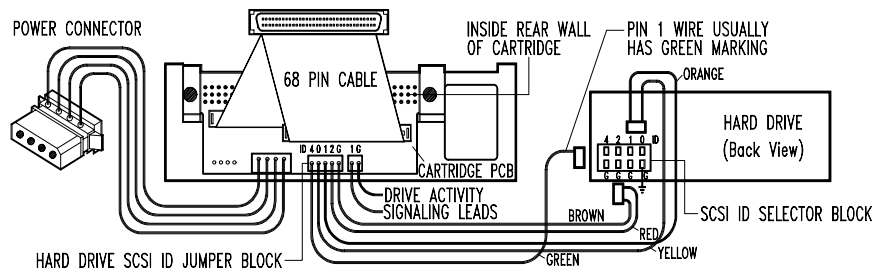

1.4 Dimensions

Unit : mm

RAID-500

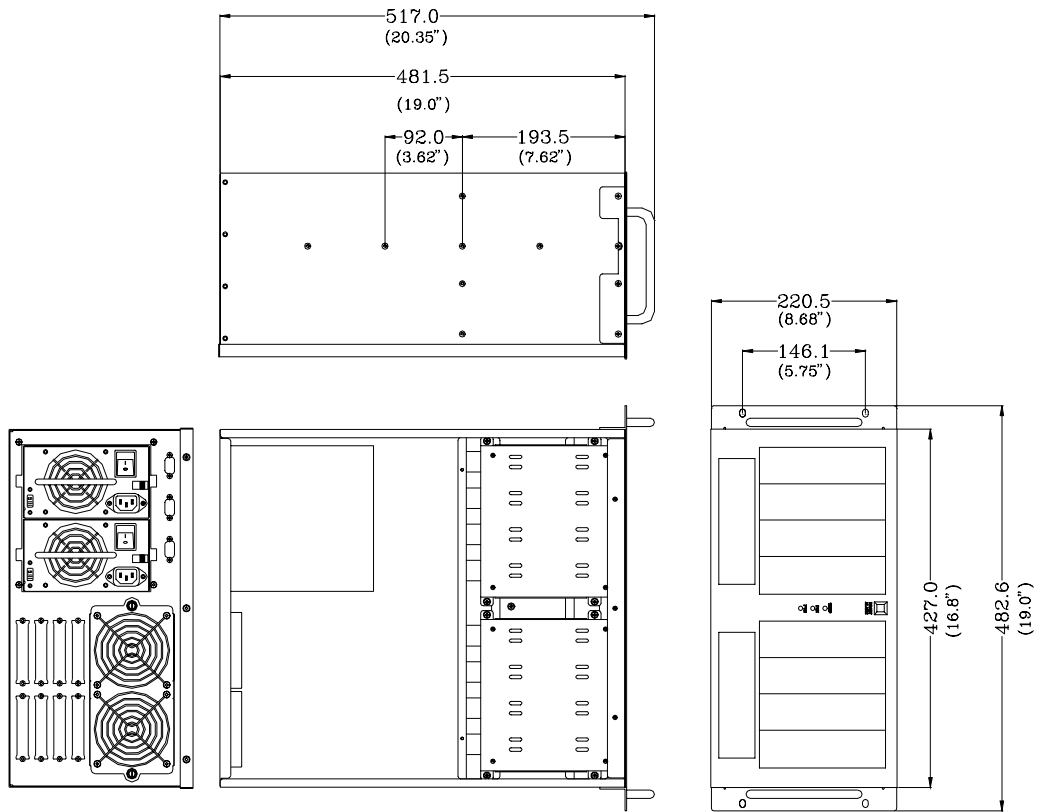

Disk Cartridge

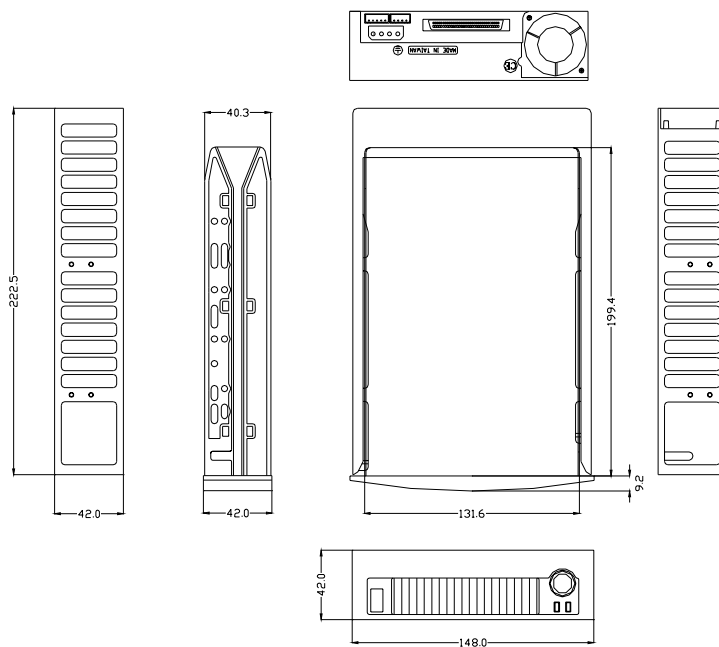

1.5 Exploded Diagram

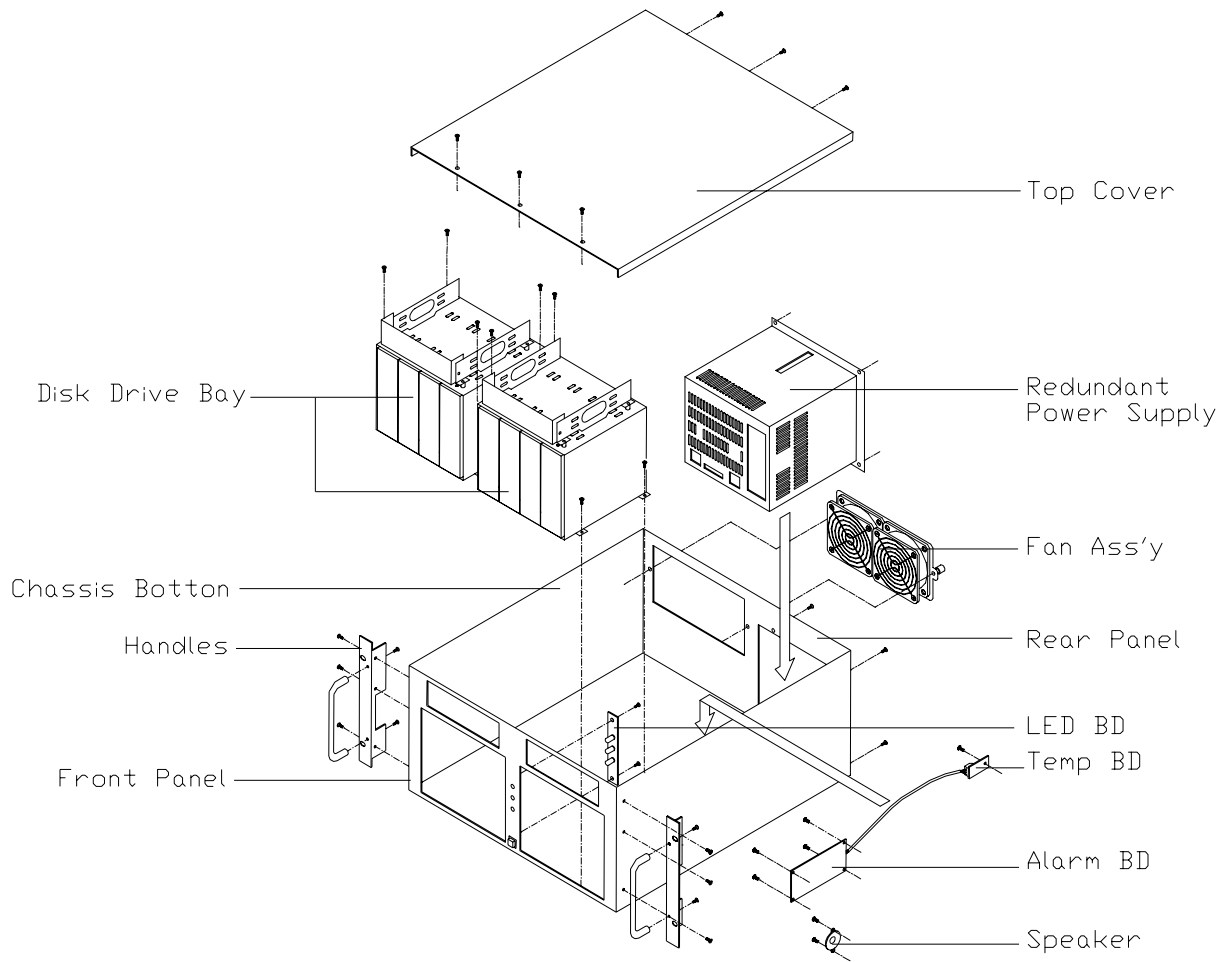

Disk Drive Bay

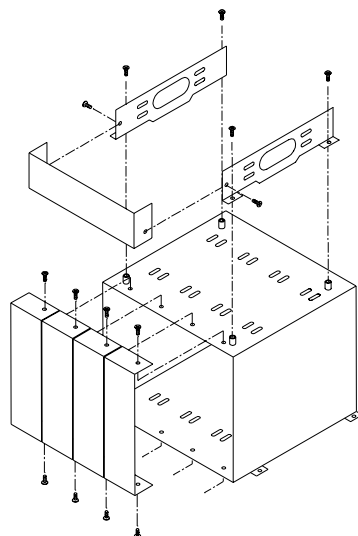

1.6 Safety Instructions

1. Please read these safety instructions carefully.
2. Please keep this User's Manual for later reference.
3. Please disconnect this equipment from AC outlet before cleaning. Don't use liquid or sprayed detergent for cleaning. Use moisture sheet or cloth for cleaning.
4. For pluggable equipment, the socket-outlet shall be installed near the equipment and shall be easily accessible.
5. Please keep this equipment from humidity.
6. Lay this equipment on a reliable surface when install. A drop or fall could cause injury.
7. The openings on the enclosure are for air convection hence protect the equipment from overheating. **DO NOT COVER THE OPENINGS.**
8. Make sure the voltage of the power source when connect the equipment to the power outlet.
9. Place the power cord such a way that people can not step on it. Do not place anything over the power cord.
10. All cautions and warnings on the equipment should be noted.
11. If the equipment is not used for a long time, disconnect the equipment from mains to avoid being damaged by transient overvoltage.
12. Never pour any liquid into opening, this could cause fire or electrical shock.
13. Never open the equipment. For safety reason, the equipment should only be opened by qualified service personnel.
14. If one of the following situations arises, get the equipment checked by a service personnel:
 - a. The power cord or plug is damaged.
 - b. Liquid has penetrated into the equipment.
 - c. The equipment has been exposed to moisture.
 - d. The equipment does not work well or you cannot get it to work according to user's manual.
 - e. The equipment has dropped and damaged.
 - f. If the equipment has obvious sign of breakage.
15. **DO NOT LEAVE THIS EQUIPMENT IN AN UNCONDITIONED ENVIRONMENT, WITH STORAGE TEMPERATURES BELOW -20°C (-4°F) OR ABOVE 60°C (140°F), AS IT MAY DAMAGE THE EQUIPMENT.**

The sound pressure level at the operator's position according to IEC 704-1:1982 is equal to or less than 70dB(A).