

# Model PS-150Z 150 Watt Power Supply Unit

## User' s Manual

### Specifications

Input	AC Input voltage rating	110-220 V <sub>AC</sub>			
	AC Input voltage range	90-264 V <sub>AC</sub>			
	AC Input frequency	47-63 Hz			
	Input surge current	60A max. @cold start for 230 V <sub>AC</sub>			
	Input current	4A Max			
Output		V1	V2	V3	V4
	O/P voltage	+5V	-5V	-12V	+12V
	Min. load current	3A	0.2A	0.2A	1A
	Typical load current (Convection cooled)	9A	0.6A	0.6A	3A
	Max. load current (Forced air 30CFM.)	15A	1A	1A	5A
	Line regulation	1%	2%	2%	2%
	Load regulation	± 5%	± 6%	± 6%	± 6%
	Cross regulation	± 5%	± 6%	± 6%	± 6%
		(At the load: V1 100% and V2, V3, V4 20% V1 50% and V2, V3, V4 100%)			
	Ripple & Noise	50 mVp-p	100 mVp-p	100 mVp-p	100 mVp-p
	Note: Peak to peak with 20MHz bandwidth and 10uf capacitor in parallel with 0.1uf capacitor				
	Over shoot	5%	6%	6%	6%
Overall Performance	Output power	150 W@ with FAN cooling (30 CFM)			
	Efficiency	70% min.@115 V <sub>AC</sub> and, Max. load			
	Hold up time	16ms min.@ 120 V <sub>AC</sub> and Max. load			
	Power factor correction	>0.9@ with Max. load meet EN61000-3-2			
Features	Over voltage protection	6.8 V max. for V1			
	Over current protection	All output equipped with short circuit protection			
Environmental	Temperature	Operating	0 ~ 50		
		Non-operating	-25 ~ 85		
	Relative humidity	Operating	20% ~ 90%		
	Cooling	30 CFM air flow @more than 100W output			
	Temperature coefficient	± 0.04% per			
Reliability	MTBF	50K hrs. min at max. load for 25 ambient temperature			
Safety standard	Designed to meet standard	UL 1950, 3 <sup>rd</sup> Edition CAS 22.2, 950-M95 TUV EN60950			
EMI standard	Input 110V limits of	FCC Class A rules			
	Input 220V limits of	EN55022 class A rules			

**Terminal Block Assignment of Power Supply**

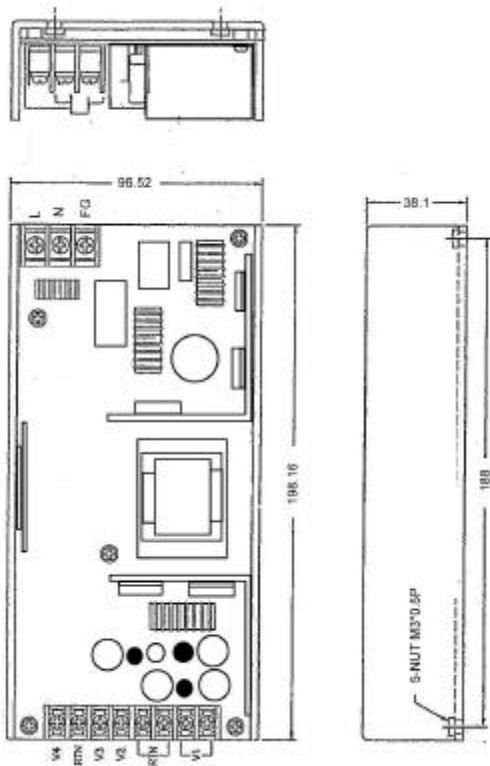

**Dimension of Mounting Bracket**

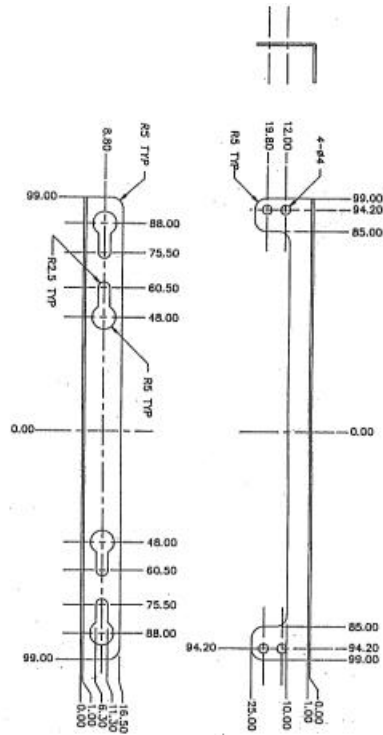

**Example of Horizontal Mounting**

**DC Wires for HDD and FDD**

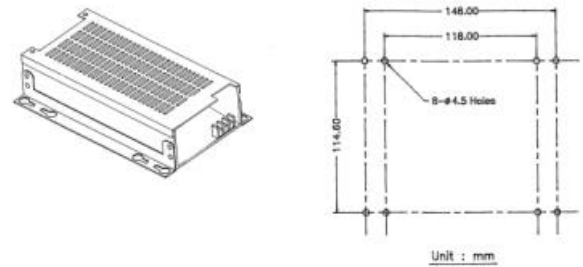
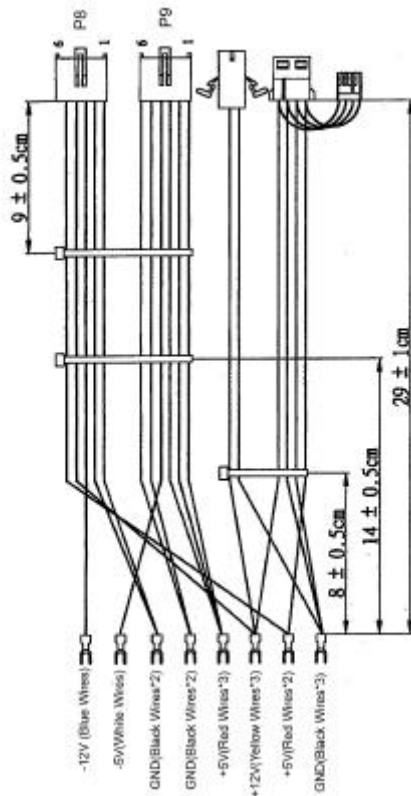

**Example of Vertical Mounting**

