

# IPC-610MB-L

## 4U Rackmount Chassis for ATX Motherboard

**NEW**



### Features

- User-friendly and front-accessible filter for system maintenance
- Front visible power and HDD LED alarm notification
- Designed to withstand environmental extremes, such as shock, vibration and high temperature
- Shock-resistant disk drive bays holds three 5.25" and one 3.5" front-accessible disk drives
- Flexible mechanical design supports both PS/2 single and redundant power supply

### Introduction

IPC-610MB-L is a 4U-high rackmount IPC chassis designed as a core block for mission-critical applications. This rugged, all-steel chassis meets the EIA RS-310C 19" rackmount standard. IPC-610MB-L comes with shockproof and front accessible drive bays, three 5.25" & one 3.5". The unit includes a high-efficiency 250/300 W ATX PFC (Power Factor Correction) power supply and one easy maintenance cooling fan which provides abundant cooling. IPC-610MB-L supports an ATX motherboard, and a wide range of standard computing peripherals can be integrated with the chassis to meet various application requirements.

### Specifications

|               |                         |   |                                   |
|---------------|-------------------------|---|-----------------------------------|
| Drive Bay     | 5.25"                   | Front-accessible  | Internal                          |
|               | 3.5"                    | 3   | 1                                 |
| Cooling       | Fan                     | 1 (84 CFM/each)   |                                   |
|               | Air Filter              | Yes   |                                   |
| Miscellaneous | Slide Rail              | General Device C-300 series supported (not included)    |                                   |
|               | Indicator               | Power & HDD activity                                    |                                   |
|               | Rear Panel              | D-SUB 9-pin and 25-pin bracket                          |                                   |
| Environment   | Temperature             | Operating   | Non-Operating                     |
|               | Humidity                | 0 ~ 40 °C (32 ~ 104 °F)                                 | -20 ~ 60 °C (-4 ~ 140 °F)         |
|               | Vibration (5 ~ 500 MHz) | -20 ~ 60 °C (-4 ~ 140 °F)                               | 10 ~ 95 % @ 40 °C, non-condensing |
|               | Shock                   | 1 Grms  | 2 G                               |
|               | Acoustic Noise          | 10 G (With 11 msec duration, 1/2 sine wave)             | 30 G                              |
|               | Altitude                | Less than 52dB sound pressure at 5 ~ 28 °C (41 ~ 82 °F) | 0 to 3048 m (0 ~ 10,000 ft)       |
| Physical      | Dimensions (W x H x D)  | 482 x 177 x 480 mm (19" x 7" x 18.9")                   |                                   |
|               | Weight                  | 10.2 kg (22.5 lb)                                       |                                   |

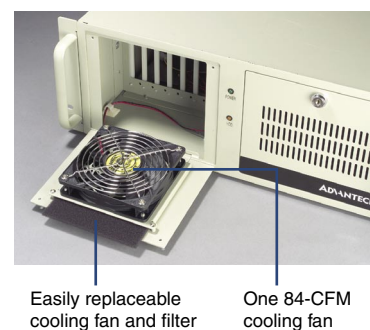
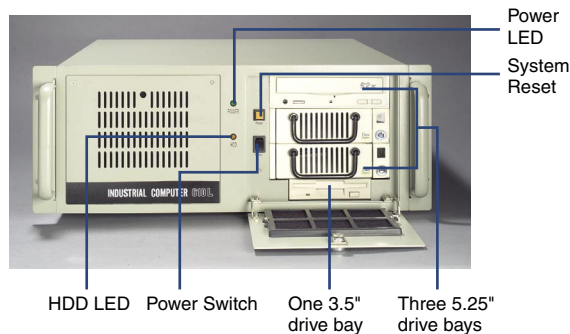

## Dimension Diagram

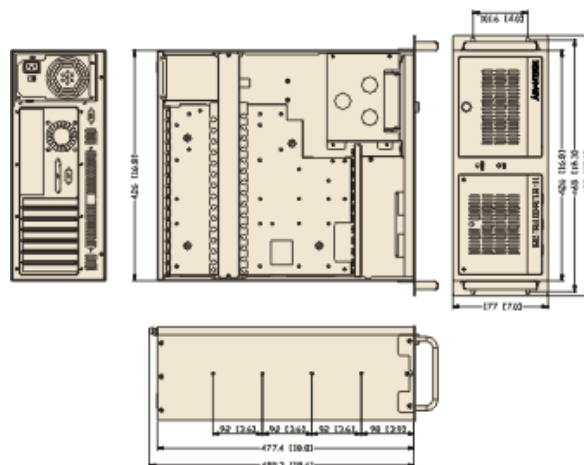

Unit: mm (inch)

## Power Supply Options

| Part Number                | Watt  | Input   | Output  | Specifications                 |  | MTBF                              |
|----------------------------|-------|---|---|--------------------------------|--|-----------------------------------|
|                            |       |   |   | Mini-load                      | Safety   |                                   |
| PS-250ATX-Z<br>(ATX, PFC)  | 250 W | AC 95 ~ 132 V<br>AC 190 ~ 264 V<br>(Selectable) | +5V @ 27 A<br>+3.3 V @ 20 A<br>+12 V @ 13 A<br>-12 V @ 0.8 A<br>-5 V @ 0.3 A<br>+5Vsb @ 2 A   | +5 V @ 0.5 A<br>+12 V @ 0.3 A  | UL/cUL (60950 3rd)<br>CE (EN61000-3-2 Class D)<br>TUV/FCC/CSA/Nemko<br>CB/CCC  | 50,000 hours @ 25 °C<br>full load |
| PS-300ATX-ZB<br>(ATX, PFC) | 300 W | AC90-264 V<br>( Full-range)                     | +5 V @ 30 A<br>+3.3 V @ 28 A<br>+12 V @ 15 A<br>-12 V @ 0.8 A<br>-5 V @ 0.3 A<br>+5 Vsb @ 2 A | +5 V @ 0.1 A<br>+3.3 V @ 0.3 A | UL/cUL(60950 3rd)<br>CE(EN61000-3-2 Class D)<br>TUV/FCC<br>CSA/Nemko<br>CB/CCC | 100,000 hours @ 25 °C             |

## Ordering Information

| Part Number    | With Power Supply                       | With Motherboard | Regulation |
|----------------|---|------------------|------------|
| IPC-610MB-00XL | Without power supply<br>with ATX switch | --               | None       |
| IPC-610MB-25ZL | PS-250ATX-Z                             | --               | UL/cUL/CE  |
| IPC-610MB-30ZL | PS-300ATX-ZB                            | --               | UL/cUL/CE  |