

HPC-7480 4U Tower/Rackmount Chassis for EATX Serverboard with 8 Hot-swap Hard Drive Cages Startup Manual

Packing List

Before you begin installing your system, please make sure that the following items have been shipped:

- Chassis
 - 1 x HPC-7480 Chassis
- Components
 - 1 x 665W PS2 power supply
 - 4 x 80*38mm 4-pin PWM fan (middle)
 - 8 x HDD tray
 - 1 x SAS/SATA hard drive backplane
 - 1 x Front I/O panel board
 - 1 x Front bezel with key
- Accessories
 - 1 x Startup manual
 - 1 x Warranty card
 - 1 x Accessory box with a package of screws
 - 1 x Front panel cable
 - 2 x System fan cable (1 to 2)

If any of these items are missing or damaged, please contact your distributor or sales representative immediately.

Note 1: Acrobat Reader is required to view any PDF file. Acrobat Reader can be downloaded at: www.adobe.com/Products/acrobat/readstep2.html (Acrobat is a trademark of Adobe)

Specifications

System Specifications

- **Construction:** Heavy-duty steel
- **Disk Drive Capacity:** Three 5.25" disk drives
- **LED Indicators on Front Panel:** Bi-color LEDs (green/red) for power, temperature, and fan status; single-color LEDs (green) for HDD activity and LAN status.
- **Switch and Buttons on Front Panel:** Power switch, system Reset button.
- **Front I/O Interfaces:** two dual USB ports.
- **Cooling System:** Four 80 mm x 38 mm hot-swappable cooling fans.
- **Air Filters:** One easily maintained filter behind the front door.
- **Power Supply:** 665 W PS2 power supply with 8cm fan
- **Operating Temperature:** 0° C ~ 40° C
- **Weight:** 29.94 kg
- **Dimensions (W x H x D):** 178 x 452 x 648 mm

For more information on this and other Advantech products, please visit our website at:

<http://www.advantech.com>

<http://www.advantech.com/epc>

For technical support and service, please visit our support website at:

<http://service.advantech.com.tw/eservice/>

This manual is for the HPC-7480 series

Part No. 2006C74810
Printed in China

1st Edition,
June 2011

Simple Maintain Process

1. Removing the Chassis Cover.

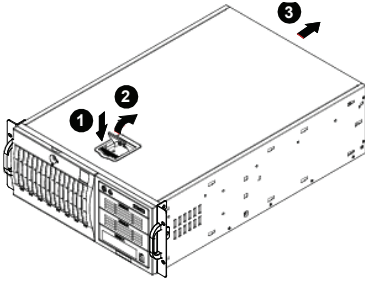

2. Accessing and Installing Hard Drives.

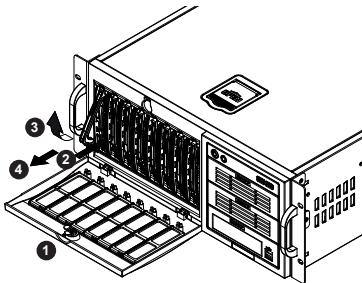

3. Installing Hard Drives into the Drive Trays.

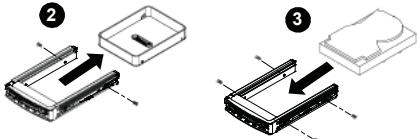

Removing the Dummy Drive

Installing the Hard Drive

4. Removing and Replacing Mid-chassis Fans.

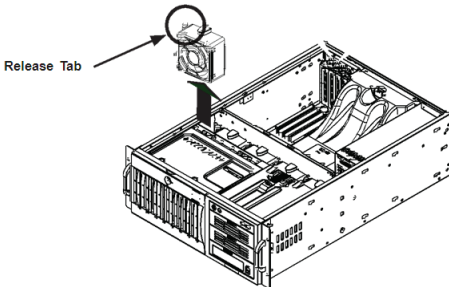

Release Tab

5. Motherboard Installation.

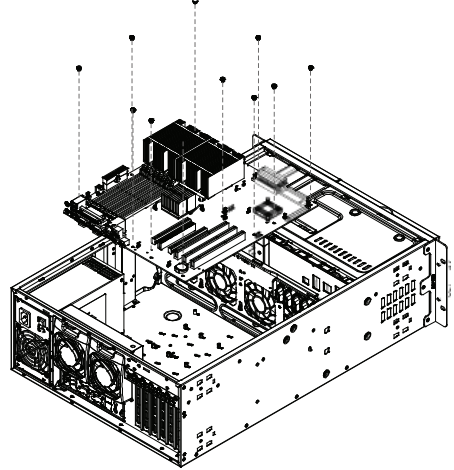

6. Installing Expansion Cards.

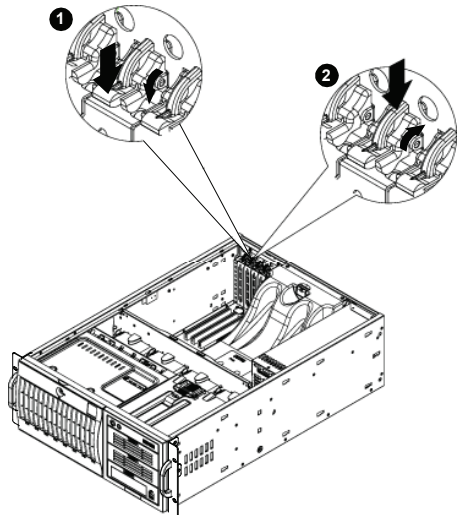

Dimensions

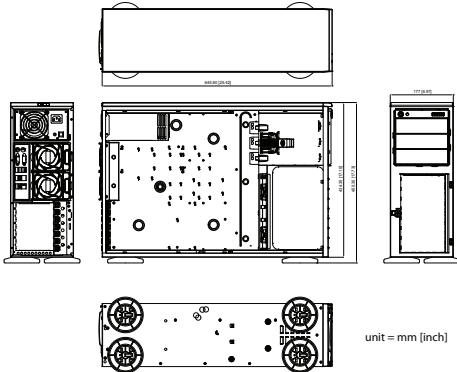

Safety Instructions

- DO NOT LEAVE THIS EQUIPMENT IN AN ENVIRONMENT WHERE THE STORAGE TEMPERATURE MAY GO BELOW -20°C (-4°F) OR ABOVE 60°C (140°F). THIS COULD DAMAGE THE EQUIPMENT. THE EQUIPMENT SHOULD BE IN A CONTROLLED ENVIRONMENT.
- CAUTION: DANGER OF EXPLOSION IF BATTERY IS INCORRECTLY REPLACED. REPLACE ONLY WITH THE SAME OR EQUIVALENT TYPE RECOMMENDED BY THE MANUFACTURER, DISCARD USED BATTERIES ACCORDING TO THE MANUFACTURER'S INSTRUCTIONS.

The sound pressure level at the operator's position according to IEC 704-1:1982 is no more than 70 dB (A).

DISCLAIMER: This set of instructions is given according to IEC 704-1. Advantech disclaims all responsibility for the accuracy of any statements contained herein.

Safety Instructions

- Read the safety instructions carefully.
- Keep this User Manual for later reference.
- Disconnect this equipment from any AC outlet before cleaning. Use a damp cloth. Do not use liquid or spray detergents for cleaning.
- For plug-in equipment, the power outlet socket must be located near the equipment and must be easily accessible.
- Keep this equipment away from humidity.
- Put this equipment on a reliable surface during installation. Dropping it or letting it fall may cause damage.
- The openings on the enclosure are for air convection. Protect the equipment from overheating. **DO NOT COVER THE OPENINGS.**
- Make sure the voltage of the power source is correct before connecting the equipment to the power outlet.
- Position the power cord so that people cannot step on it. Do not place anything over the power cord.
- All cautions and warnings on the equipment should be noted.
- If the equipment is not used for a long time, disconnect it from the power source to avoid damage by transient overvoltage.
- Never pour any liquid into an opening in the unit. This may cause fire or electrical shock.
- Never open the equipment. For safety reasons, the equipment should be opened only by qualified service personnel.
- If one of the following situations arises, get the equipment checked by service personnel:
 - The power cord or plug is damaged.
 - Liquid has penetrated into the equipment.
 - The equipment has been exposed to moisture.
 - The equipment does not work well, or you cannot get it to work according to the user's manual.
 - The equipment has been dropped and damaged.
 - The equipment has obvious signs of breakage.

Safety Precaution - Electricity

Follow these simple precautions to protect yourself from harm and the products from damage.

- To avoid electrical shock, always disconnect the power from your PC chassis before you work on it.
- For the sake of the equipment, disconnect power before making any configuration changes. The sudden rush of power as you connect a jumper or install a card may damage sensitive electronic components.
- Electronic components are also vulnerable to damage by electrostatic discharge. An electrostatic charge can build up on the human body, especially where the air is dry. At minimum, dissipate potential body charge before handling any electronic board by touching a conductive surface on the chassis. Only then remove circuit boards from their antistatic bags.
Handle boards by the edges or mounting brackets only; do not touch components or connecting pins.