

UbiQ-230T

One-Touch Scenario Control Panel with 3.5" Color LCD

NEW



Features

- Seven programmable scenario keys
- 3.5" color Touch TFT LCD
- Built-in IR receiver
- Remote Manager tool for SI development
- Replaceable faceplate
- Dimmer package supported
- Ethernet & RS-485 interface
- Modbus & UPNP supported

Introduction

The UbiQ-230T, a 3.5" scenario control panel with seven programmable hot keys for one-touch operation, is a new member of the Advantech control panel family that targets the Home/Building-Residential/Commercial Automation fields. It seamlessly integrates seven front-bezel keys for intuitive selection of home scenarios and four D I/O, an RS-232, RS-422 & RS-485 ports for versatile protocol connections. Also, UbiQ-230T operates like a traditional control panel offering a simple interface with flexible and expandable control protocols such as RS-485, LonWorks®, DALI, and Modbus to provide versatile control capacities. The UbiQ-230T offers scheduled energy management of home lighting, HVAC, blind, dimmer and power devices to deliver the perfect way of creating a home comfort zone. In addition, the UbiQ-230T dimmers and relays are included in the Scenario control package, so system integrators can easily build Smart Home applications.

Product Highlights

The UbiQ-230T's smart and friendly scenario keys and vivid color touch panel puts personal comfort zones within easy reach:

1. Seven programmable scenario keys and touchscreen for unlimited scenario setting
2. Home scenario modes make customized lighting, HVAC, blind, audio and video device preferences available with one touch.
3. Scenario manager tool for system integrators to further customize home scenario configuration through a PC.

Specifications

Motherboard	Kernel	32-bit ARM 9 Low Voltage 200 MHz SDRAM: 64 MB Flash: 128 MB
Audio	1 W speaker Line-out	
Control Protocol Options	Default SSP is reserved for other protocols	RS-485
Display	DataImage 3.5" Touch TFT LCD with 240 x 320 resolution LCD Power Control	3.3 V VDD, 5 V VBK Control & Bus
I/O Ports	Ethernet Serial ports Consumer IR receiver for remote control, up to 10 meters Fully compatible with UbiQ-310 7 programmable function keys as scenario buttons	10/100Base-Tx 1 x RS-485, 1 x SSP
Power Supply	DC-in	10 ~ 28 V wide range DC input
Software	OS Utilities	Windows CE 5.0 (Core Version) Advantech Scenario manager for configuration by SIs
Mechanical Specifications	Wall box for Installer Plastic Enclosure Dimensions (W x H x D) Weight Reserved	9.1 x 12.1 x 1.0 cm (3.58" x 4.76" x 0.39") 260 g (0.57 lb) 1 x RS-485 Phoenix type connector
Environment Specifications	Operating Temperature Relative humidity Safety EMS EMI	0 ~ 50° C (32 ~ 122° F) 10 ~ 95% @ 40° C (non-condensing) UL, CUL, CE CE Class B FCC, CE Class B

System Dimensions

Unit: mm

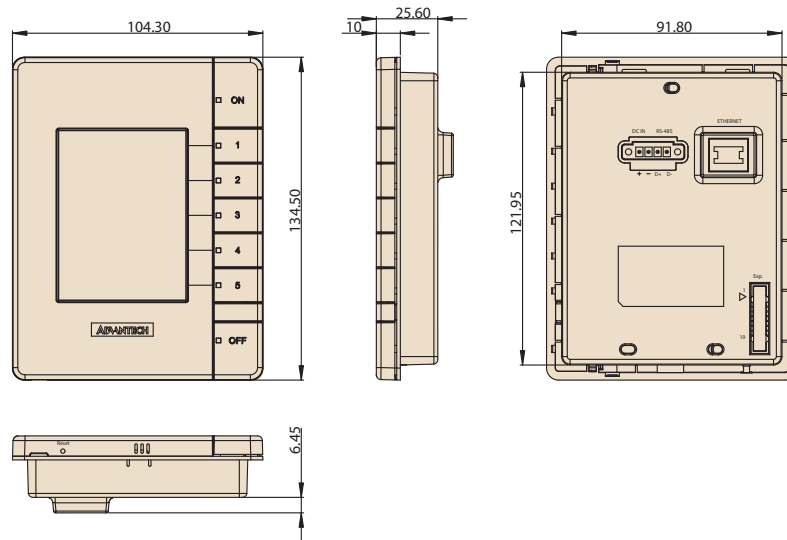

Wallbox Dimensions

Unit: mm

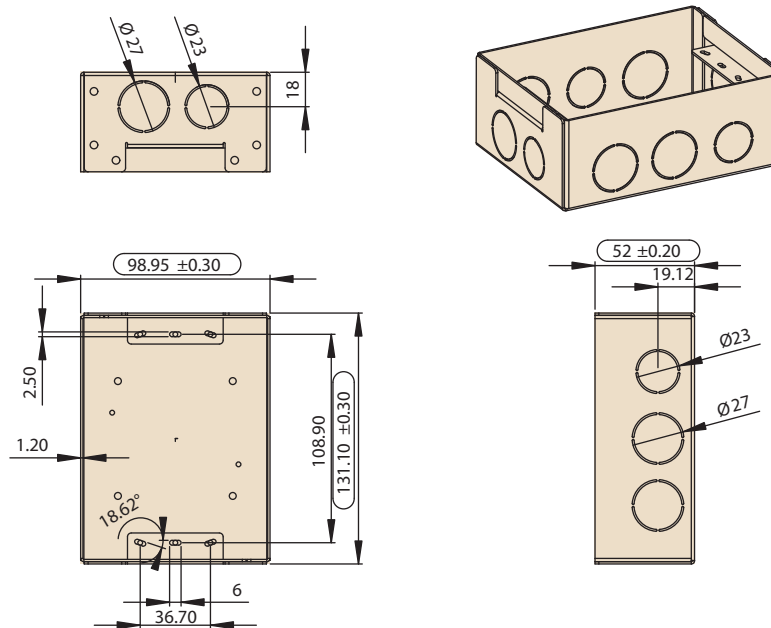

Ordering Information

Part Number	Description
UbiQ-230T-CE0E	3.5" Scenario Controller with touch panel
UbiQ-Dimmer-04	Liteputer EDX-F04 4Ch Dimmer w/UbiQ protocol
UbiQ-230-Wallbox	In-wall box for UbiQ-230

Packing List

Description	Quantity
CD Utility	1
Cable	1
Mounting frame	1
Screws	1
Deco plate	1