

ACP-2010MB/ 2320MB

2U Rackmount Chassis for ATX/ MicroATX Motherboard with Low-Profile Rear Bracket Option



Features

- LED indicators and audible alarm notification for system fault detection
- Shock-resistant drive bays to hold one 5.25" and three 3.5" drives for ACP-2010MB (one front-accessible and two internal); one slim optical disk drive, two internal 3.5" drives and dual mobile SAS/SATA HDD trays for ACP-2320MB
- Various riser card options to support three full-length PCI or PCIe cards for expansion
- Supports 300 W / 400 W ATX PFC power supply
- Reusable and washable air filters



Specifications

Disk Drive Bay	Slim Optical Disk Drive	Front-accessible	Internal
	5.25"	- / 1	-
	3.5"	1 / 0	-
Cooling	Fan	2 (47 CFM each) / 2 (47 CFM each) + 1 (28 CFM)	
	Air Filters	Yes	
Front I/O Interface	USB	2	
	PS/2	1	
Miscellaneous	Notification LEDs	Power, HDD, Temperature, Fan	
	Rear Panel	Reserved two 9-pin D-Sub openings	
Environment	Temperature	Operating 0 ~ 40° C (32 ~ 104° F)	Non-operating -20 ~ 60° C (-4 ~ 140° F)
	Humidity	10 ~ 85 % @ 40° C, non-condensing	10 ~ 95 % @ 40° C, non-condensing
	Vibration (5-500 Hz)	1 Grms	2 G
	Shock	10 G (with 11 ms duration, half sine wave)	30 G
	Physical Characteristics	Dimensions (W x H x D)	482 x 88 x 480 mm (19" x 3.46" x 18.9")
	Weight	10.7 kg (23.5 lb) / 11.7 kg (25.7 lb)	

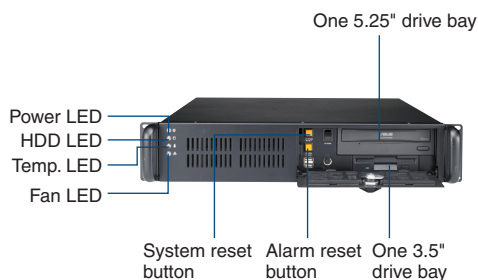

Inside View of ACP-2010MB



Rear View

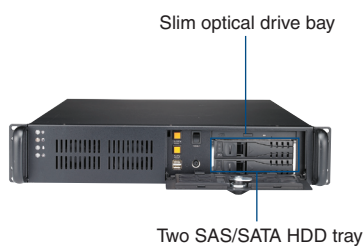

Inside View of ACP-2320MB



Rear I/O bracket for low profile add-on cards

Dimensions

Unit: mm (inch)

ACP-2010MB

ACP-2320MB

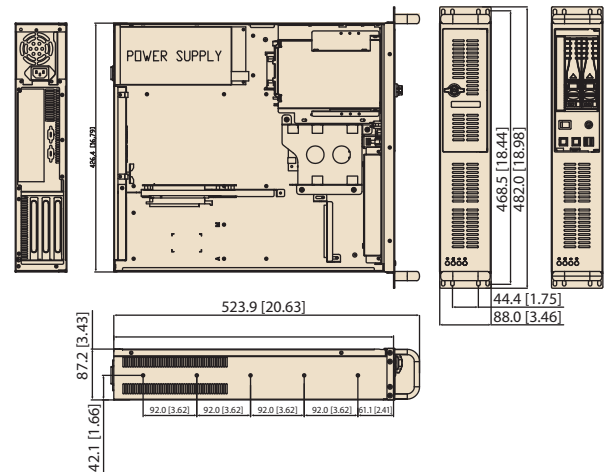
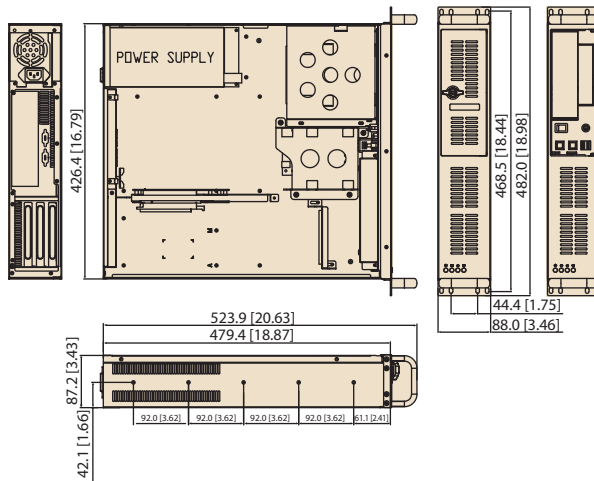

Power Supply Options

Part Number	Watt	Input	Output	Specifications		
				Mini-load	Safety	MTBF
1757000007G (ATX, PFC)	300 W	AC 100 – 240 V (full range)	+5 V @ 35 A, +3.3 V @ 20 A, +12 V @ 16 A, -5 V @ 0.5 A, -12 V @ 1 A, +5 Vsb @ 2 A	+5 V @ 3 A, +3.3 V @ 1 A, +12 V @ 2 A, -5 V @ 0.05 A, -12 V @ 0.05 A, +5 Vsb @ 0.1 A	UL/TUV/CB/CCC	97,800 hrs @ 25° C
1757000105G (ATX, PFC)	400 W	AC 100 – 240 V (full range)	+5 V @ 25 A, +3.3 V @ 20 A, +12 V @ 28 A, -5 V @ 0.5 A, -12 V @ 0.5 A, +5 Vsb @ 2 A	+5 V @ 3 A, +3.3 V @ 1 A, +12 V @ 2 A, +5 Vsb @ 0.1 A	UL/TUV/CB/CCC	100,000 hrs @ 25° C

Accessories

Part Number	Description
9680002285	Rear I/O bracket for low-profile add-on cards
96CD-52X-I-AS-B3	Black 5.25" 52X CD-ROM
96DVR-40X-I-AS-B	Black 5.25" 16X/40X/24X DVDRW-ROM
96FDD-144-TE-B	Black 3.5" FDD
SDVD-FDD-COMBOE	5.25" storage kit with slim 8X DVD, 24X CD-RW & standard 3.5" black FDD
SDVD-COMBOE	5.25" storage kit with slim 8X DVD, 24X CD-RW & a 3.5" drive bay for FDD or HDD
SCD-FDD-COMBOE	5.25" storage kit with slim 24X CD-ROM & standard 3.5" black FDD
SCD-COMBOE	5.25" storage kit with slim 24X CD-ROM & a 3.5" drive bay for FDD or HDD
SDVD-CDRW	Black slim 8X DVD + 24X CD-RW with 40-pin IDE connector
SCD-ROM	Black slim 24X CD-ROM with 40-pin IDE connector
1759200650	Fan 80 x 80 x 25 mm
1750000191	Fan 60 x 60 x 25 mm (for ACP-2320MB)
1700060202	Y-cable for PS/2 mouse and keyboard
9662132000E	Black 3.5" mobile HDD tray

Riser Card Options

Model Name	Interface	Expansion Slot	Motherboard
AIMB-R4301-03A1E	PCIe x4	Three PCIe x1	762/764/554/556, 762 & 554 only support one PCIe x1 (the lowest slot)
AIMB-R430P-03A1E	PCIe x4	Three PCI	AIMB-762/764/554/556
AIMB-R431F-21A1E	PCIe x4 + PCIe x16	One PCIe x16 + two PCIe x1	AIMB-762/764/554/556; 762 & 554 support only one PCIe x1 (the lowest slot) except one PCIe x16
AIMB-RP30P-03A1E	PCI	Three PCI	AIMB-740/742/744/750/760/542/552/560; AIMB-542 only support one PCI (the lowest slot)
AIMB-RP3PF-21A1E	PCI + PCIe x16	One PCIe x16 + two PCI	AIMB-763/562/564
AIMB-RH31P-12A1E	PCI+ PCIe x1	Two PCI + one PCIe x1	AIMB-760

* The riser cards are specially designed to support all Advantech AIMB series motherboards. There might be compatibility issues with other vendor's motherboards, so an optional rear I/O bracket for low-profile add-on cards is provided.

Ordering Information

Part Number	Power Supply	Motherboard	Regulation
ACP-2010MB0-00XBE	Without power supply, with ATX switch	Supports AIMB-7XX & AIMB-5XX series. Riser card is not included.	-
ACP-2010MB0-30ZBE	1757000007G		CE
ACP-2320MB0-00XBE	Without power supply, with ATX switch	Supports AIMB-7XX & AIMB-5XX series. Riser card is not included.	-
ACP-2320MB0-30ZBE	1757000007G		CE